

How to Handwash?

WASH HANDS WHEN VISIBLY SOILED! OTHERWISE, USE HANDRUB

 **Duration of the entire procedure: 40-60 seconds**

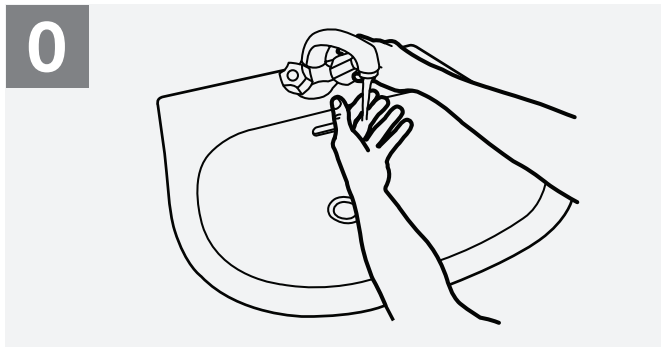

Wet hands with water;

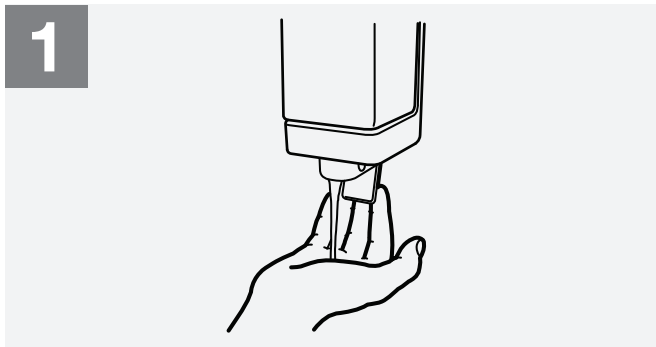

Apply enough soap to cover all hand surfaces;

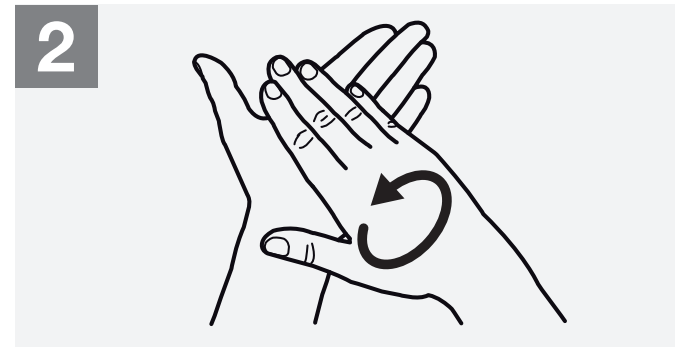

Rub hands palm to palm;

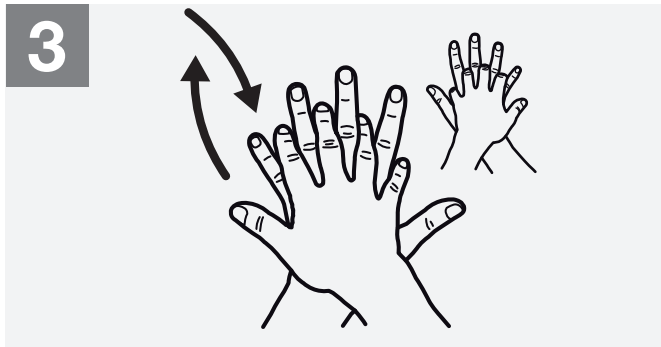

Right palm over left dorsum with interlaced fingers and vice versa;

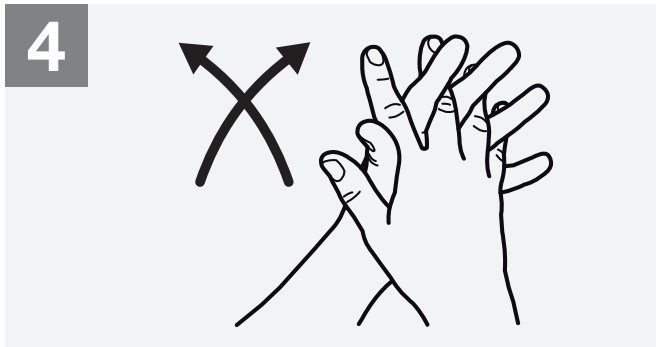

Palm to palm with fingers interlaced;

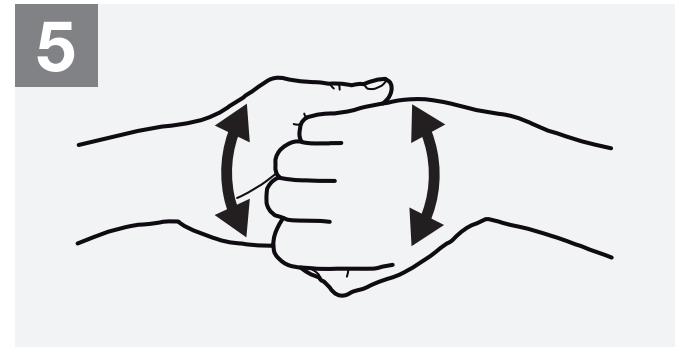

Backs of fingers to opposing palms with fingers interlocked;

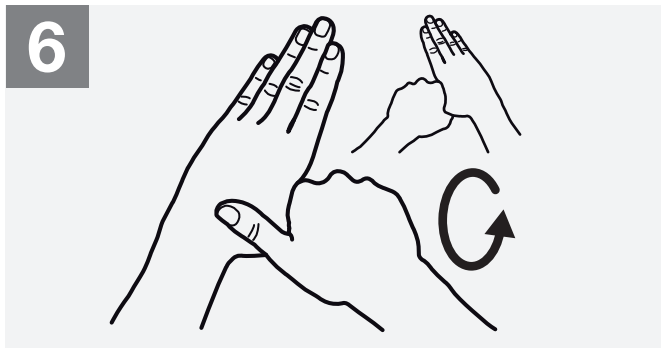

Rotational rubbing of left thumb clasped in right palm and vice versa;

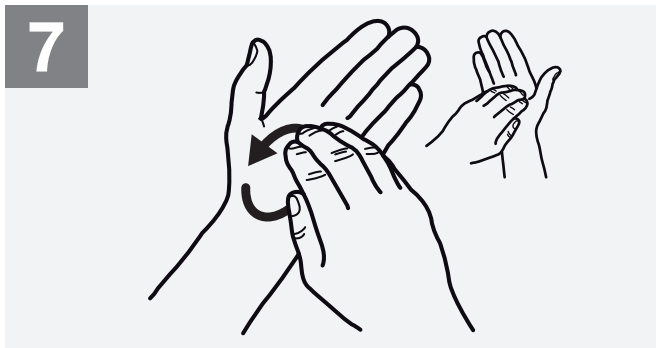

Rotational rubbing, backwards and forwards with clasped fingers of right hand in left palm and vice versa;

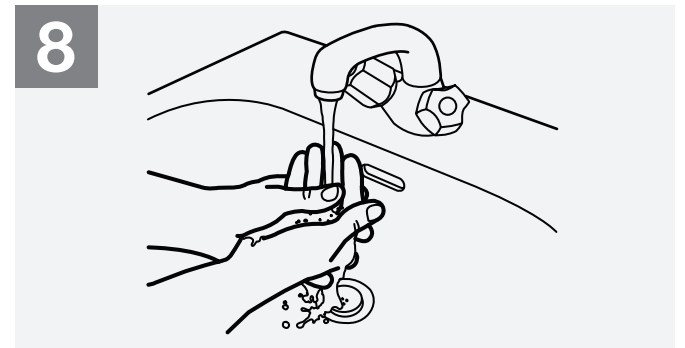

Rinse hands with water;

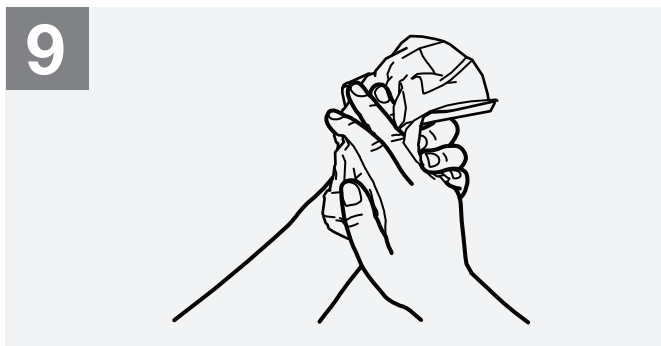

Dry hands thoroughly with a single use towel;

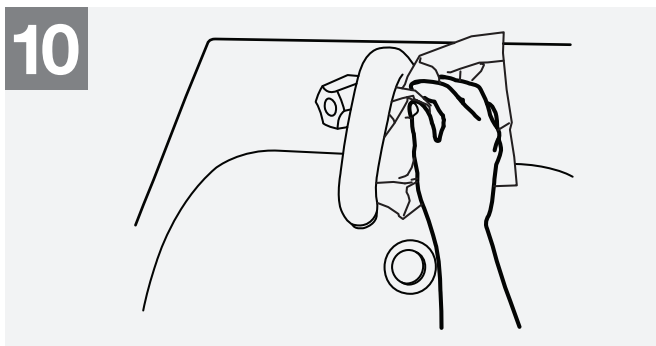

Use towel to turn off faucet;

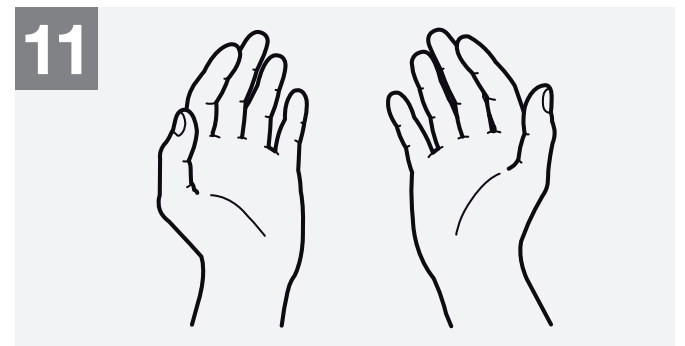

Your hands are now safe.